

WingBAT 48E

Designed by: Stan Yeo
 1220mm Span Electric Sports Model

All Wood Balsa unless otherwise stated

CONTROL SETTINGS
 Ailerons Up 13mm Down 12mm
 Elevator Up 9mm Down 8mm
 Balance point 122mm +/- 3mm
 Target Weight 890gms (2lb)

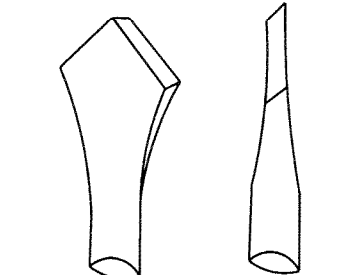
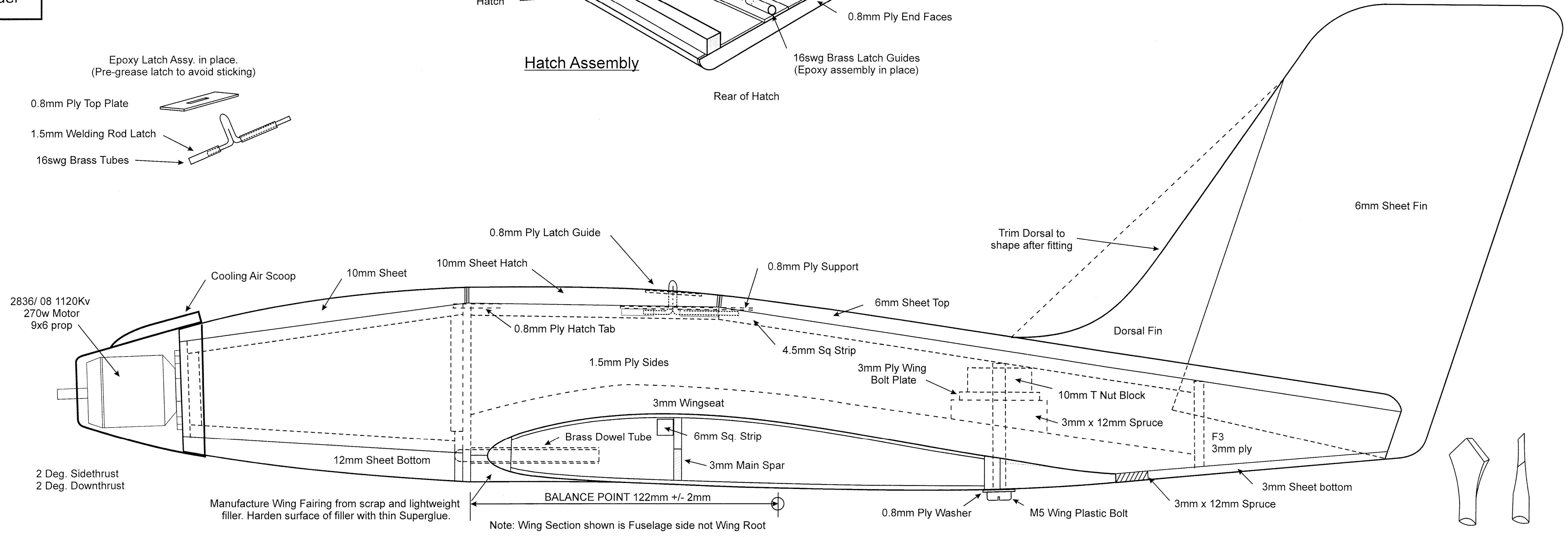
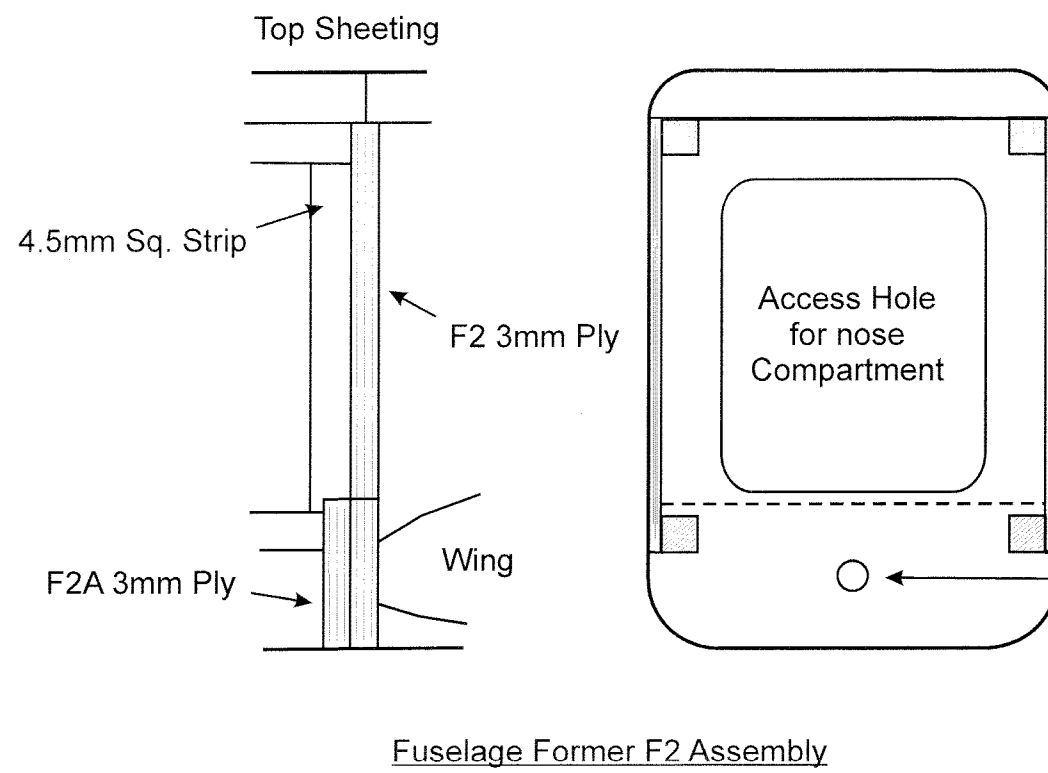
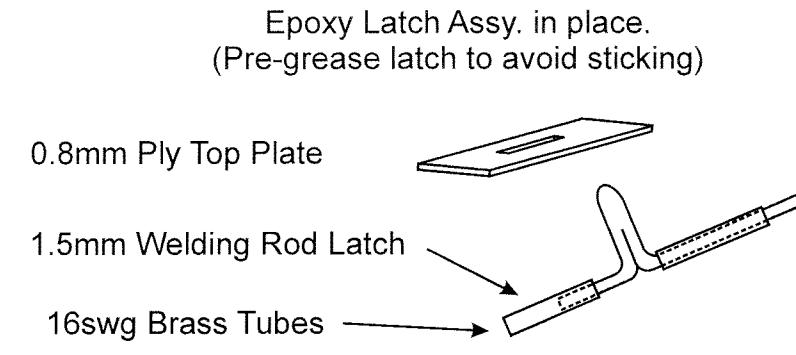
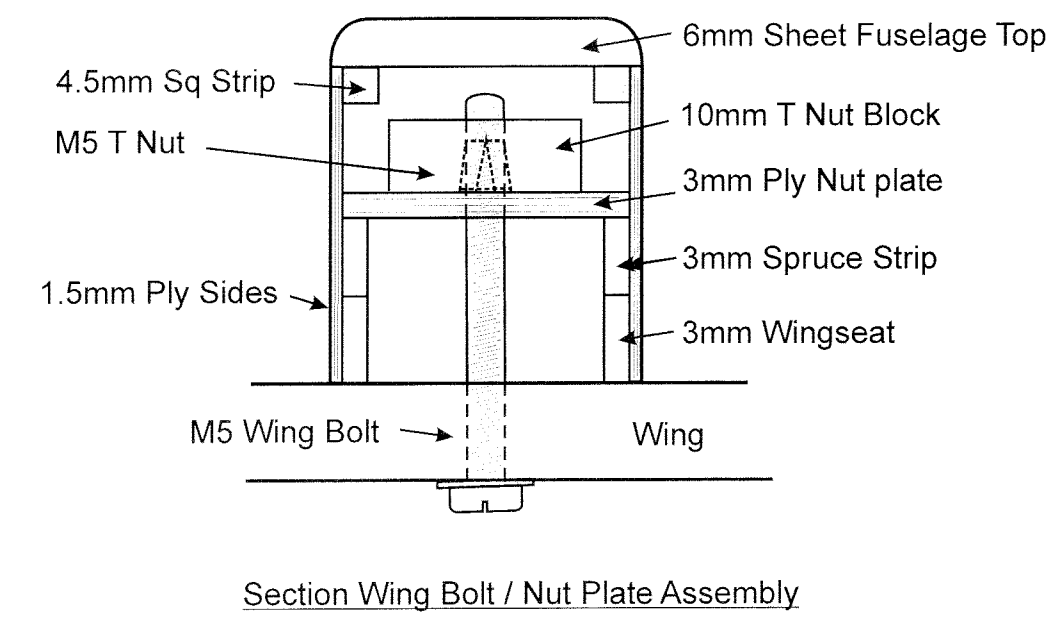
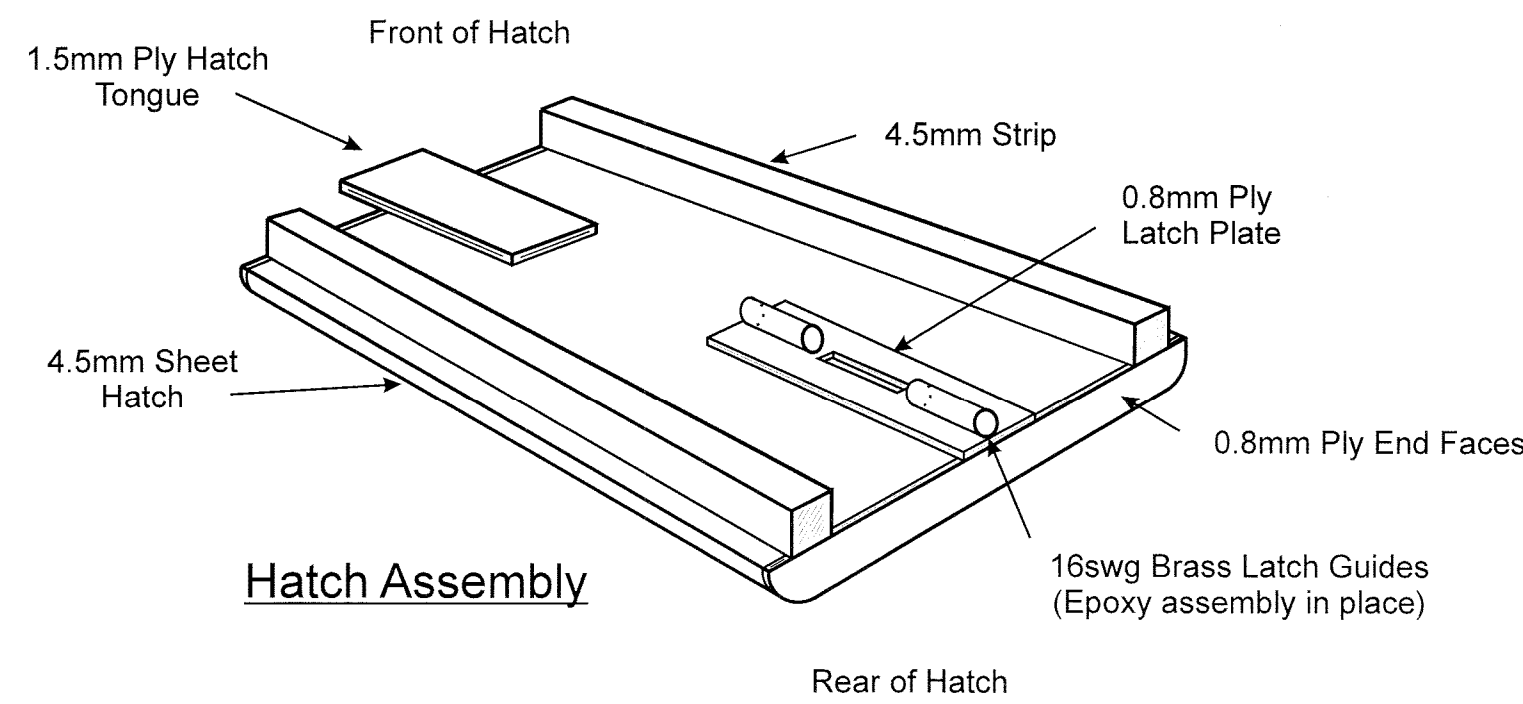

Wing Dowel Drill
 1.Heat end of 450mm 4mm Dia. Piano wire & flatten end
 2.Shape as above and grind in rake to assist in cutting
 3. Heat tip to cherry red and quench in water.
 4. Drill hole to check diameter and adjust as necessary.

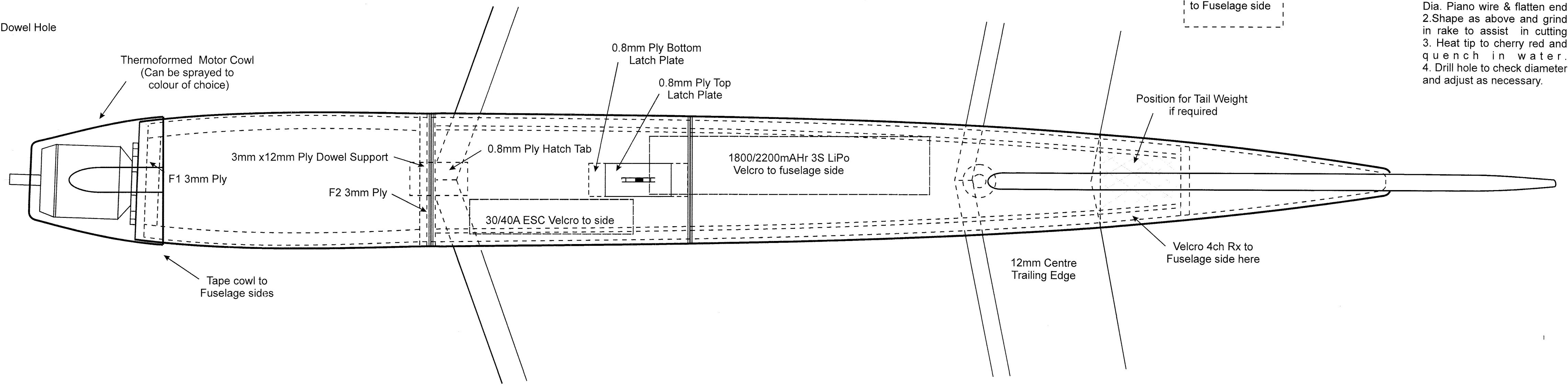

- Abbreviated Wing Building Instructions**
1. Build Lift & Right Hand wing panels minus Top sheeting.
 2. Join Wing as per Plan.
 3. Add Centre Section Structure.
 4. Pin one wing panel to building boards at the Root and Tip LE.
 5. Using 'Washout Webs' pin TE to building board.
 6. Fit Top sheeting.
 7. repeat for second panel wing.
 8. Continue building Wing as per instructions.

WingBAT 48E

Designed by: Stan Yeo
 1220mm Span Electric Sports Model

All Wood Balsa unless otherwise stated

CONTROL SETTINGS

Ailerons Up 13mm Down 12mm
 Elevator Up 9mm Down 8mm
 Balance point 122mm +/-3mm
 Target Weight 680gms (1lb 8oz)

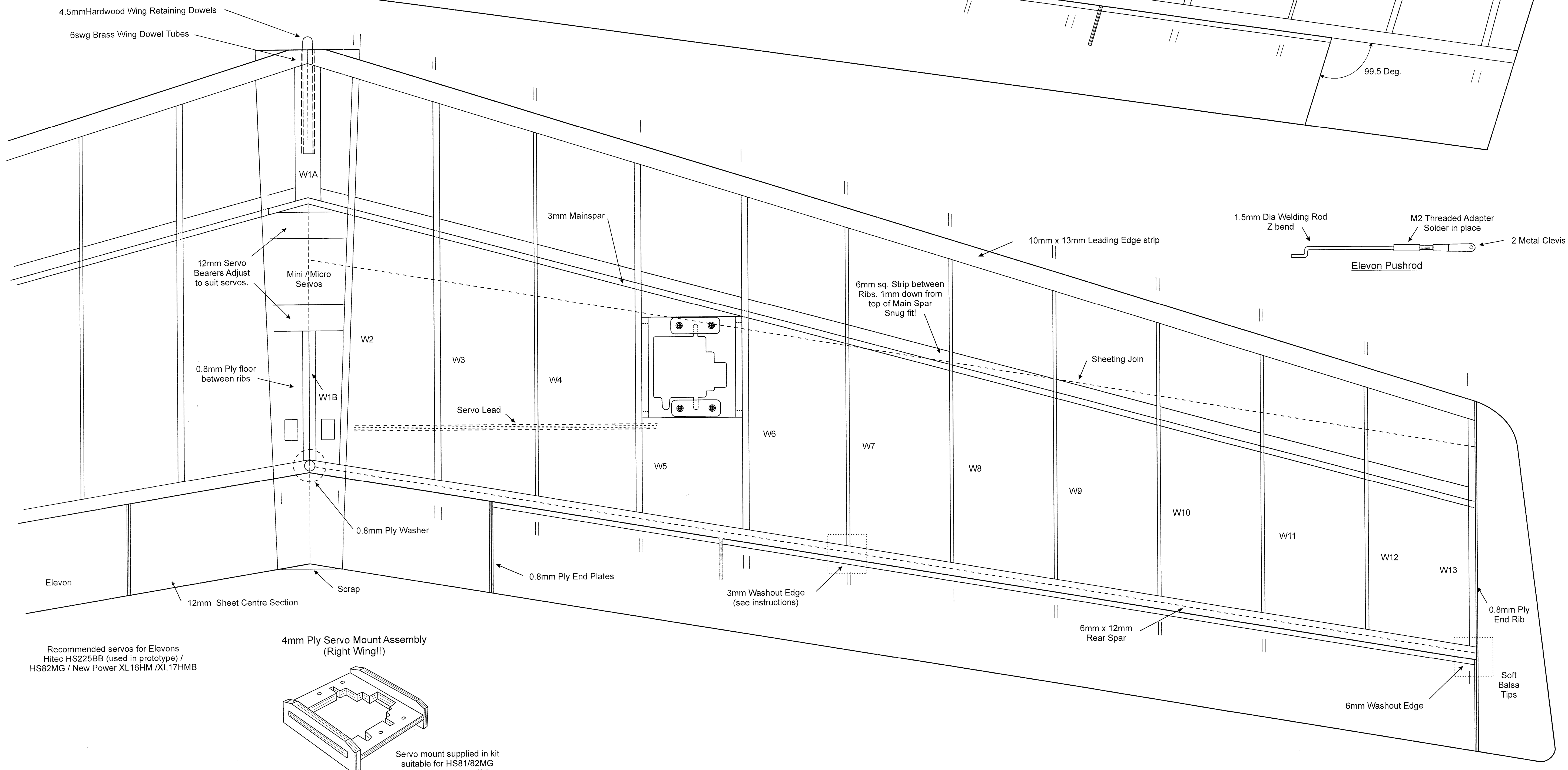

Recommended servos for Elevons
 Hitec HS225BB (used in prototype) /
 HS82MG / New Power XL16HM /XL17HMB

4mm Ply Servo Mount Assembly
 (Right Wing!!)

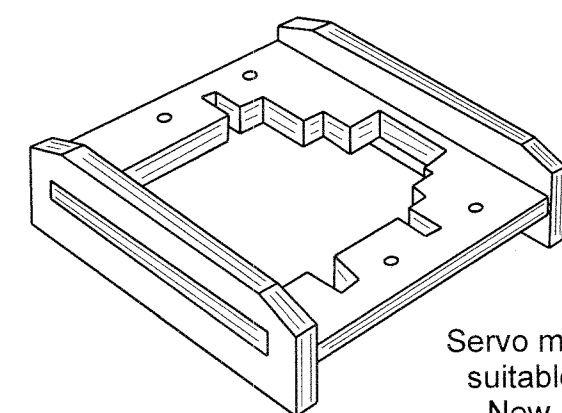

Servo mount supplied in kit
 suitable for HS81/82MG
 New Power XL-16/17